

Digilant Xtern-Cam® - Solar Powered Outdoor Wireless Surveillance Camera

March 2010

Xtern-Cam® is a rugged outdoor standalone surveillance camera with inbuilt GPRS modem, digital image recording function, integrated night vision and inbuilt Solar Panel to give extraordinary long battery life.

It is the first product to be released as part of the Digilant® *Solar Smart®* range of surveillance cameras and is a bundled product consisting of a Digilant® wireless surveillance camera, re-chargeable battery, remote control, 2GB memory card, card reader, battery charger and PC configuration software.

The camera captures high-resolution black & white images when motion is detected and emails a selection of these to a monitoring station or mobile phone as well as storing all the high resolution images to a removable memory card for easy viewing later, on a computer or PDA. The camera can also be powered by an external 12VDC power source and can be externally triggered from a gate or door opening.

Outdoors in **time lapse** mode using its inbuilt Solar panel to recharge the battery during the day, **Xtern-Cam®** can capture and transmit wirelessly, one image every hour at night time without ever requiring the battery to be re-charged.

If motion activated in busy environments where the Camera may capture and transmit up to 100 images per night, the battery would still last around **1 month!**

The camera can store up to **65,000 VGA images** and will optionally overwrite the oldest images when the memory card is full to enable **'set and forget'** operation.

Xtern-Cam® is also available with a colour camera for daytime operation with optional **16mm or 8mm telephoto lenses**.

For more information on the full range of the Digilant® surveillance cameras, please visit our website at www.digilant.com.au

FEATURES

- Unique *Solar Smart®* “standalone” outdoor wireless (GPRS) surveillance camera
- Operates indefinitely, taking up to 25 photos/night using its Solar Powered battery
- “Set & Forget” operation
- Inbuilt invisible IR Flash for true covert night vision
- Motion activated or time lapse mode
- Compact, lightweight and portable
- Rugged UV resistant weatherproof case (IP65) for harsh outdoor environments
- Customised image-capture sequence and image encryption
- Time and date stamped images with programmable text overlay
- Flexible scheduler for independent arming and disarming of camera
- Digital signature including camera ID, within each image for integrity verification
- Optional Colour camera available for daytime operation
- Optional 16mm or 8 mm Telephoto lens
- Ideal for monitoring farm gates & sheds, livestock, construction sites, holiday homes, residential & business etc.



Farm Gates



Construction Sites

CAMERA & ACCESSORIES

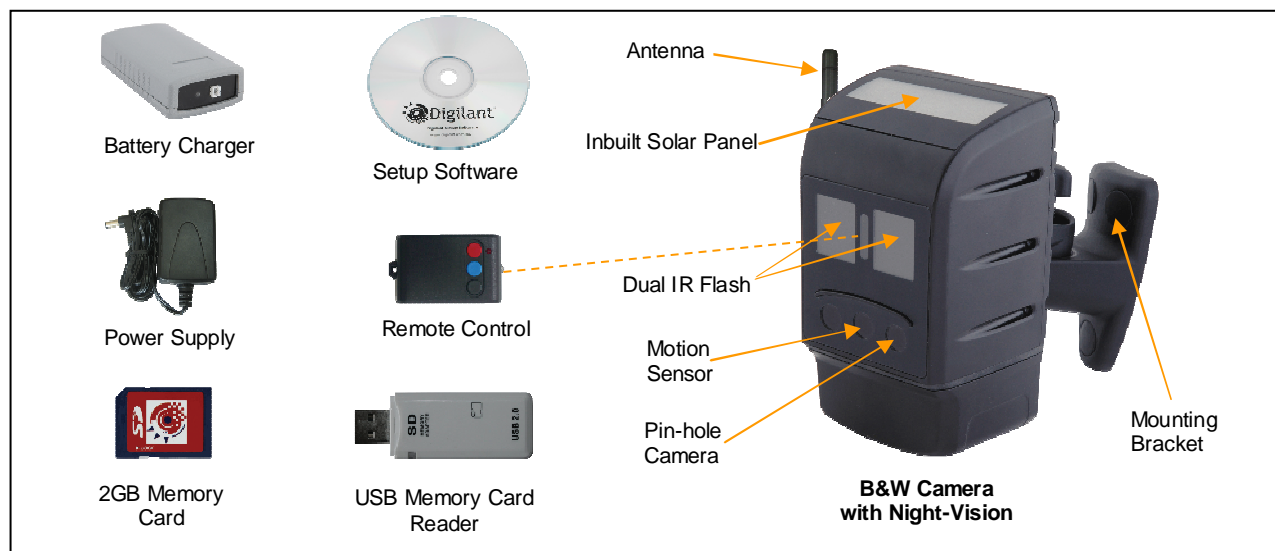

SPECIFICATIONS - CAMERA

Image Type	Black & White or Colour, JPEG compressed VGA (640x480pixels), QVGA (320x240)
Camera Lenses	Wide angle: 3.3mm, AOV: 73°(D) x 61°(H) x 47°(V) Telephoto: 16mm, AOV: 17°(D) 8mm, 40°(D)
Image Sensor Sensitivity	Colour: 3.8 V/Lux-sec, B&W: 4.9 V/Lux-sec
Motion Sensor (PIR)	Range: 0-5 m (16')(Typical), 0-7.5 m (25') (Maximum) FOV: 38° horizontal, 22° vertical
Inbuilt Flash options	Type: Invisible IR LED Range: 0-3 m (9.8') Type: Visible IR LED Range: 0-5 m (16.4')
Inbuilt Solar Panel	Power output = 0.17W (Full sunlight)
Memory Card	MMC™ Card (v4.2) or SD™ Card (v1.1), FAT16 file format
Storage Capacity (B&W)	2GB Memory Card VGA: 65,000 images, QVGA: 65,000 images
External Power Supply (Battery must be connected for IR spot)	5 VDC, 300mA 9VDC to 24V DC, 300 mA (with optional interface board)
Internal Battery Capacity	Very high Capacity (VHCB) – Lithium Ion, 3.7V 7.5Ah
Power Consumption	Standby: 1.9 mA , Running: 100 mA, with IR: 900 mA
Case Dimensions & Rating	84 x 144 x 72 mm (3.3" x 5.7" x 2.8"), IP 65
Weight	350g (12oz) – Including battery
Operating Temperature	-20°C to +60°C (-4° F to 140° F)
PC Software Requirements	Windows 2000 (SP4), Windows XP (SP2), Windows Vista

SPECIFICATIONS - MODEM

Cellular Bearer	GSM + GPRS Class 10
Radio Bands	Quad band 850/900/1800/1900
Approvals	R&TTE, CE, GCF, FCC, PTCRB, China RTE, AT&T
Nominal Sensitivity	850/900 MHz Rx: 104dBm
Power Consumption	Sleep: 17uA , Idle: 1.7 mA, GPRS (33dBm): 300mA
Dimensions	65 x 45 x 15 mm (2.6" x 1.8" x 0.6")
Weight	20g (12oz)
Operating Temperature	-20°C to +55°C (-4° F to 131° F)